

Property Exhibit

of

Eastview Elementary School

A Portion of Tax Parcel ZOP 00003A,
located in the Northeast 1/4 of Section 36, Town 2 North, Range 17 East, City of Lake Geneva, Walworth County, Wisconsin.

Legal Description
Lands described in a Quit Claim Deed recorded January 15, 1951 in Vol. 424 on Page 251 as Document No. 432114 as shown below:

A parcel of land located in the Northeast Quarter of Section 36, Town 2 North, Range 17 East of Walworth County, Wisconsin, being in the City of Lake Geneva, Walworth County, Wisconsin described as follows, to-wit: Beginning at an iron pipe in the North line of Section 36, 440 feet East of the North Quarter Section corner of said Section 36, which point is located in the East line of Sage Street, thence East along the Section line 843.10 feet to an iron pipe; thence South 2° 57' West 263.55 feet to an iron pipe; thence South 22° 08' West 610.55 feet to an iron pipe; thence South 34° 24' West 149.89 feet to an iron pipe; thence South 48° 13' West 111.97 feet to an iron pipe; thence South 59° 55' West 47.23 feet to an iron pipe; thence South 89° 58' West 84.65 feet to an iron pipe; thence continue South 89° 58' West 311.55 feet to an iron pipe located in the East line of Sage Street; thence North 0° 19' East 1050.0 feet along the East line of said Street to the place of beginning.

Surveyed for: **Lake Geneva Schools**
208 South Street
Lake Geneva, Wisconsin. 53147

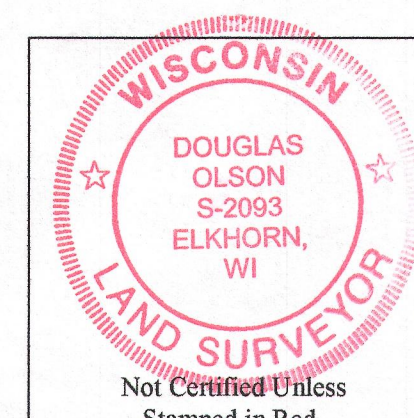
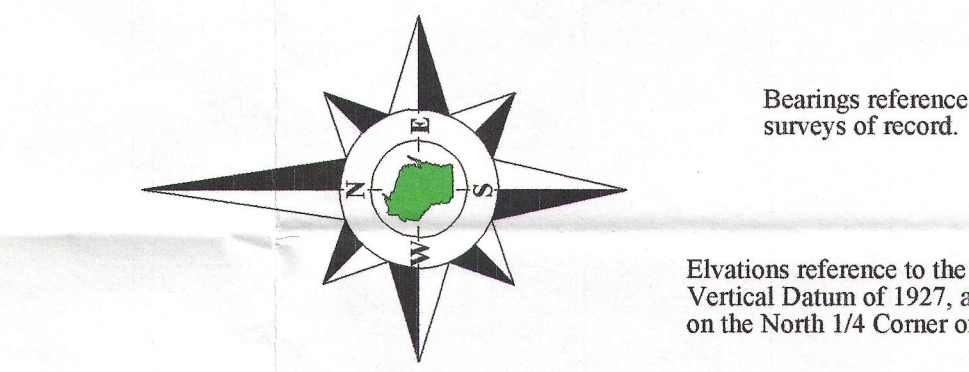

Notes:
1) This survey plat is not certified unless signed and sealed in red ink.
2) This survey is subject to Wisconsin lien laws. This Plat of Survey is the notice of intent to file lien. Lien waiver required.

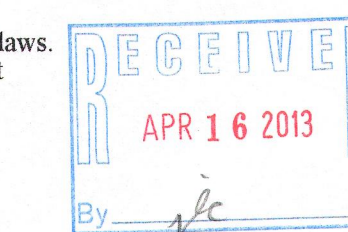

Copyright 2013 by Jensen & Olson Land Surveying, LLC.

All rights reserved. No part of this survey plat may be reproduced or transmitted in any form by any means - graphic, electronic, or mechanical, including photocopying, tracing, or information storage and retrieval systems - without permission in writing from Douglas G. Olson, Jensen & Olson Land Surveying, LLC.

I, Douglas G. Olson, Wisconsin Registered Land Surveyor, do hereby certify that this survey was performed by me, or under my direction in full compliance with the owner's/agent's instructions and Chapter A-E 7 of the Wisconsin Administrative Code "Minimum Standards for Property Surveys"; and that this map is an accurate representation thereof to the best of my knowledge and belief.

Douglas G. Olson
Wisconsin Registered Land Surveyor - 2093

Survey date: February 6, 2013.
Revisions:

Scale in Feet
1" = 20'

Jensen & Olson Land Surveying, LLC
45 South Wisconsin Street * P.O. Box 322 * Elkhorn, Wisconsin. 53121
Telephone: (262) 723-3434 * Facsimile: (262) 723-8044
Email: jensen.olson@elknet.net

Legend
Found County Section Corner
Found Iron Pipe
Recorded Information
Utility Pole
Manhole or Concrete Cover
Diggers Hotline Flag
Concrete Surface
Gravel Surface
Hydrant
Water Valve
Deciduous Tree
Coniferous Tree
Pole With Basketball Hoop

Sheet 1 of 1 Sheets
Job Reference Number
2013.006

2013.006

ZOP 00003A 007-2936